

# PS600 CS-17-1

## Solar surface pump system

### Applications

- Swimming pool filtration
- Pond management
- Irrigation

### Characteristics

- Fast, failure-free installation
- Excellent serviceability
- High reliability and life expectancy
- Short Return of Investment (ROI) cycle
- Lower Total Cost of Ownership (TCO)

### Technical data

Total dynamic head	max. 12 m
Flow rate	max. 19 m <sup>3</sup> /h
Vmp*	> 68 V
Voc	max. 150 V

### Standards

**CE** 2006/42/EC, 2004/108/EC, 2006/95/EC

The logos shown reflect the approvals that have been granted for this product family. Products are ordered and supplied with the approvals specific to the market requirements.



### Components

#### Controller: PS600

- Controlling and monitoring
- Control inputs for dry running protection, remote control etc.
- Protected against reverse polarity, overload and overtemperature
- Integrated MPPT (Maximum Power Point Tracker)
- Low voltage disconnect for battery operation

#### Motor: ECDRIVE 600 CS-17

- Maintenance-free brushless DC motor
- No electronics in the motor

#### Pump end: PE CS-17-1

- High reliability and life expectancy
- Suction headmax. 3 m
- Premium materials
- Optional: dry running protection

## PS600 CS-17-1

### Solar surface pump system

#### Pump chart

Vmp\* > 68 V

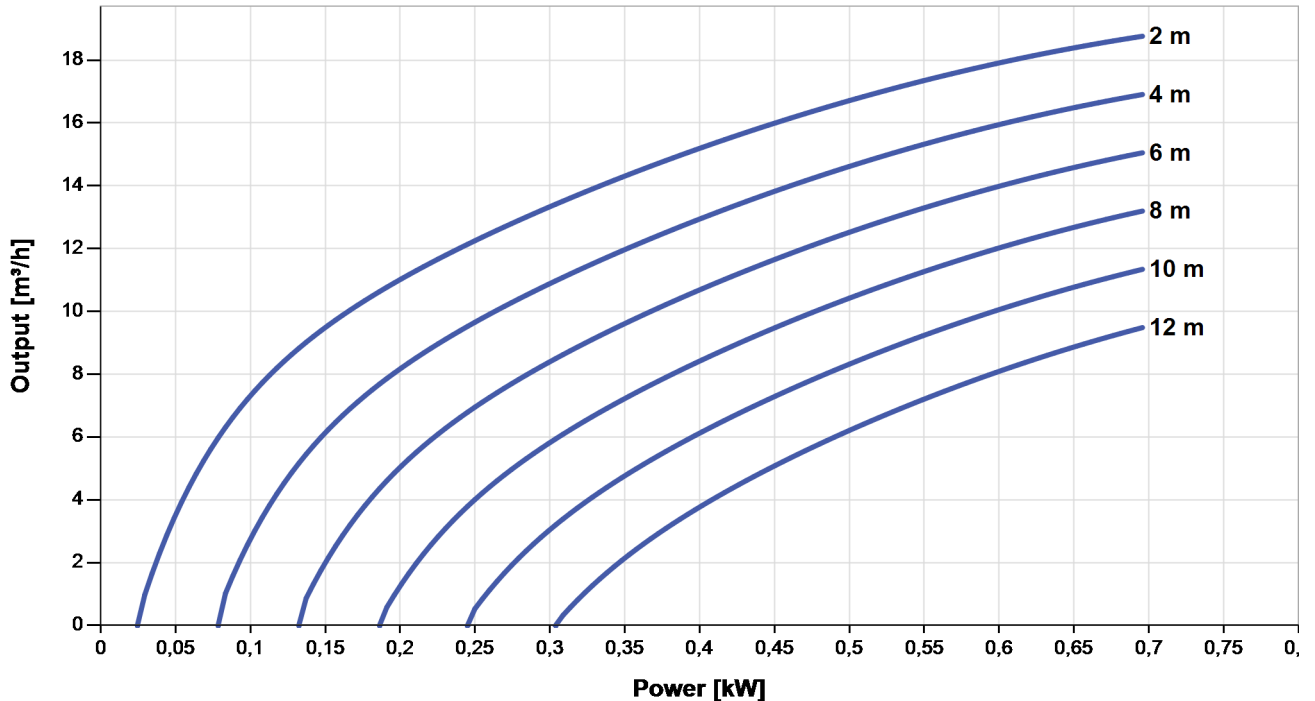

#### Dimensions and weights

##### Controller

H = 396 mm  
 H2 = 364 mm  
 W1 = 178 mm  
 W2 = 156 mm  
 W3 = 116 mm  
 D = 165 mm  
 D1 = 150 mm

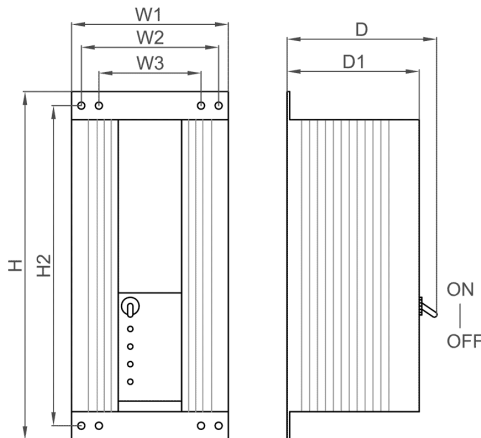

##### Pump unit [mm]

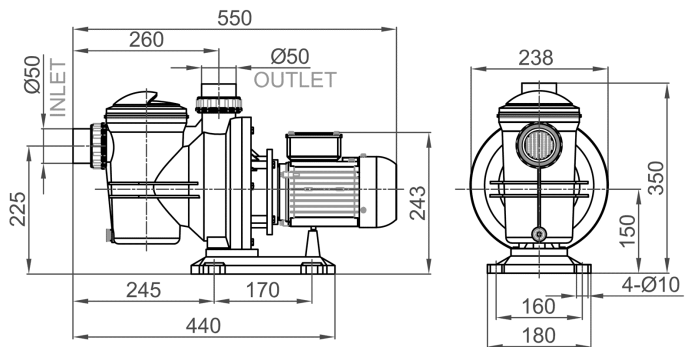

	Net weight
Controller	4,5 kg
Pump unit	8,7 kg
Motor	7,0 kg
Pump end	1,7 kg

\*Vmp: MPP-voltage under Standard Test Conditions (STC): 1000 W/m² solar irradiance, 25 °C cell temperature